

✉ post@ba-lighting.no
🌐 www.ba-lighting.no



EPE-3W-EM

LED Emergency Downlight

CE CB  RoHS



INTRODUCTION

EPE-3W-EM Emergency down light is controlled by smart IC, with self-test function. Two optional lens (oval&round shape) for different applications. It has removable front cover design, adapter ring available. With external driver and external battery in separated, convenient for maintenance.

FEATURES

- Oval lens for escape route application.
- Round lens for open area application.
- LiFePO4 battery, long life time.
- High power & efficiency LED.
- 80mm adapter ring for bigger cuthole included.

Black / White



Dimensions

unit:mm

55mm trim plate

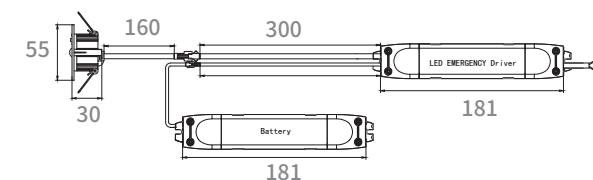

80mm trim plate

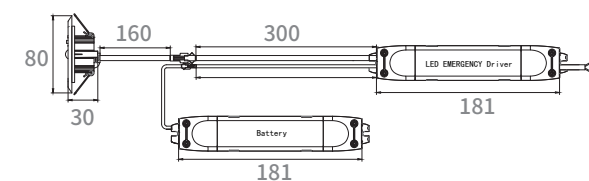

Square Trim Plate



Dimensions unit:mm

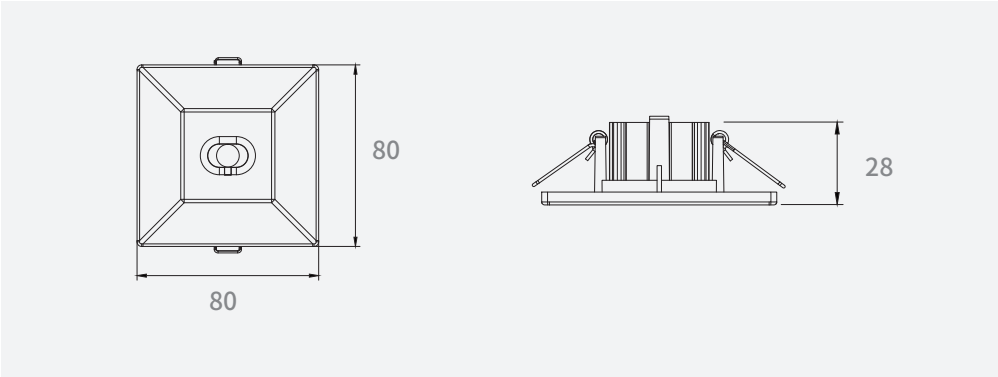

Model List

Model	Input Voltage	Mains Power	Emergency Power	Charge Duration	Discharge Duration	Battery	Test Mode
EPE-3W-EM-MT-1H	200-240VAC	3.5W Max	2W Max	24H	1H	LiFePO4 6.4V600mAh	Manual Test
EPE-3W-EM-MT-3H	200-240VAC	3.5W Max	2W Max	24H	3H	LiFePO4 6.4V1500mAh	Manual Test
EPE-3W-EM-AT-1H	200-240VAC	3.5W Max	2W Max	24H	1H	LiFePO4 6.4V600mAh	Auto Test
EPE-3W-EM-AT-3H	200-240VAC	3.5W Max	2W Max	24H	3H	LiFePO4 6.4V1500mAh	Auto Test

Driver Datasheet

Model	EPE-3W-EM
Mains Power	3.5W Max
Frequency	50/60Hz
Input Voltage	AC200-240V
Efficiency	≥70%
Emergency Power	2W Max
Power Factor	≥0.3
Input Current	≤0.03A
Full load output voltage	DC2.8-3.2V
Output current	600mA±10%
Short circuit protection	PASS
Over voltage protection	PASS
Over temperature protection	PASS
THD	—
Surge	0.5KV
Withstand voltage	AC3750V

Finishing color	White RAL 9016
Material	Aluminum+PC
Glow wire test (°C)	COVER:850 °C / LENS:650 °C
Operating Temp.(°C)	0 °C ~45 °C
Storage Temp.(°C)	0 °C ~65 °C

Change Lens (Optional)

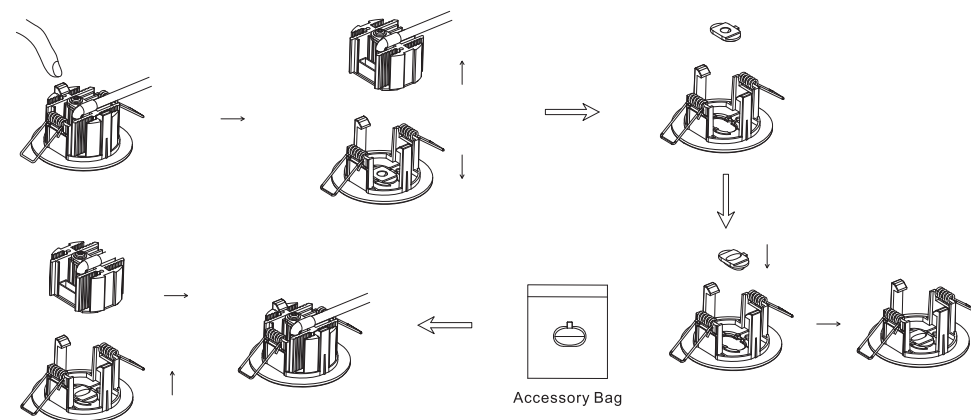

Technical Datasheet

Model		EPE-3W-EM
LED		SMD LED 3535
CCT(K)		5000K
"Luminous Flux(lm) ±10%"	Non-DIM	240lm(1H/3H)
CRI		>70
LED Driver		Built-out
Protection Class		Class II
IP Rating		IP20

Photometric Data

Oval lens for escape route application

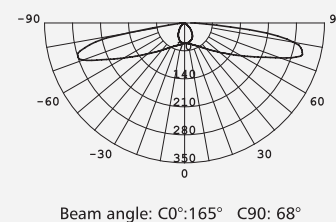

Round lens for open area application

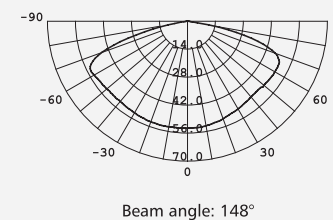

Instructions for automatic test option

1. Instruction for Automatic test function

Once the unit is powered up, a self-diagnostics test will be automatically initiated:

- Check battery, lamp, charge board and transfer fault all the time.
- Run 3mins duration test every month.
- Run 1H or 3H duration test every year.

Note: All test functions are preset and no need field adjustment.

2. Dual Colour LED Status Indicator Meaning

- Green indicator solid on: Ready/ Normal Operation
- Red indicator flashes: Require service

•	One flash, 4s pause	Battery disconnected
••	Two flashes, 4s pause	Low battery voltage
•••	Three flashes, 4s pause	Charge board fault
••••	Four flashes, 4s pause	AC/DC transfer fault
•••••	Five flashes, 4s pause	LED lamp fault

Note: When the fault is recovered, press the test button for 2s, the red flashing indicator will turn green.
The fault is cleared, and the unit is back to normal.

3. Button Test

Press test button once	run a 30s duration test
Press test button twice within 2s	run a 3mins duration test
Press test button 3 times within 2s	run a 30mins duration test
Press test button 4 times within 2s	run a 1H or 3H duration test



www.ba-lighting.no post@ba-lighting.no Tlf.: 37 16 04 00

Adr.: Holthesvei 2, 4848 Arendal