



FDV

HS-K Serie

LED Low Profile Linear High Bay



HS-HB50W-K (1 module)



PHILIPS



L:305mm

W:122mm

H:95mm

All Dimensions are in[mm]

Electro-Optical Characteristics

Features

Input Voltage(typ)	AC100-528V	Operating Temperature	-40□to+55□		
Tested@(Voltage)	120Vac	Dimmable	YES (0-10V)		
Power Consumption	50w	Housing Material	high heat-conducting aviation aluminum		
Current Consumption	0.83A	Lens Material	PC		
Efficacy:(Lm/w)	170	Housing Color	White/Black		
Lumens	8500lm	Driver	MEANWELL		
Total Ft-Cd	-cd	Protection Rating	IP66		
Power Factor	0.95	Warranty	7Years		
CRI(Ra)	80	SMD LED/Qty.	77pcs		
CCT	2700-6000k	Net weight	2.7kg		
Viewing Angle	60/90/120°	Outer carton size(cm)	39.5*19.5*17cm		
LED source	PHILIPS 3030Leds	G.W per ctn	3.7kg		
Part No.	BA278,BA279	DWG NO.	HS1528	Page	2 of 5

HS-HB100W-K (2 modules)



PHILIPS

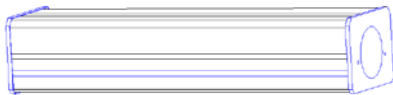

H:95mm

W:122mm

L:600mm

All Dimensions are in[mm]

Electro-Optical Characteristics

Features

Input Voltage(typ)	AC100-528V	Operating Temperature	-40□to+55□		
Tested@(Voltage)	120Vac	Dimmable	YES (0-10V)		
Power Consumption	100w	Housing Material	high heat-conducting aviation aluminum		
Current Consumption	0.83A	Lens Material	PC		
Efficacy:(Lm/w)	170	Housing Color	White/Black		
Lumens	17000lm	Driver	MEANWELL		
Total Ft-Cd	-cd	Protection Rating	IP66		
Power Factor	0.95	Warranty	7Years		
CRI(Ra)	80	SMD LED/Qty.	154pcs		
CCT	2700-6000k	Net weight	3.6kg		
Viewing Angle	60/90/120°	Outer carton size(cm)	69.5*19.5*17cm		
LED source	PHILIPS 3030Leds	G.W per ctn	4.7kg		
Part No.	BA272, BA282	DWG NO.	HS1528	Page	3 of 5

HS-HB150W-K (3 modules)



PHILIPS



H:95mm

L:895mm

W:122mm

All Dimensions are in[mm]

Electro-Optical Characteristics

Features

Input Voltage(typ)	AC100-528V	Operating Temperature	-40□to+55□		
Tested@(Voltage)	120Vac	Dimmable	YES (0-10V)		
Power Consumption	150w	Housing Material	high heat-conducting aviation aluminum		
Current Consumption	0.83A	Lens Material	PC		
Efficacy:(Lm/w)	170	Housing Color	White/Black		
Lumens	25500lm	Driver	MEANWELL		
Total Ft-Cd	-cd	Protection Rating	IP66		
Power Factor	0.95	Warranty	7Years		
CRI(Ra)	80	SMD LED/Qty.	231pcs		
CCT	2700-6000k	Net weight	5.6kg		
Viewing Angle	60/90/120°	Outer carton size(cm)	98.5*19.5*17cm		
LED source	PHILIPS 3030Leds	G.W per ctn	6.7kg		
Part No.	BA271, BA280	DWG NO.	HS1528	Page	4 of 5

HS-HB200W-K / HS-HB250W-K (4 modules)



PHILIPS



L:1190mm

H:95mm

W:122mm

All Dimensions are in[mm]





Electro-Optical Characteristics

Features

Input Voltage(typ)	AC100-528V	Operating Temperature	-40□to+55□		
Tested@(Voltage)	120Vac	Dimmable	YES (0-10V)		
Power Consumption	200w/250w	Housing Material	high heat-conducting aviation aluminum		
Current Consumption	0.83A	Lens Material	PC		
Efficacy:(Lm/w)	170	Housing Color	White/Black		
Lumens	34000lm/42500lm	Driver	MEANWELL (ELG-240)		
Total Ft-Cd	-cd	Protection Rating	IP66		
Power Factor	0.95	Warranty	7Years		
CRI(Ra)	80	SMD LED/Qty.	308pcs		
CCT	2700-6000k	Net weight	6.9kg		
Viewing Angle	60/90/120°	Outer carton size(cm)	128*19.5*17cm		
LED source	PHILIPS 3030Leds	G.W per ctn	8.2kg		
Part No.	BA289	DWG NO.	HS1528	Page	5 of 5



Installation accessories for choosing

	HS-01	A, Standard fittings with 2pcs buckles,if need other installation way, the price for accessories are as follows
	HS-02	A, Suspended Mounting B, Chain length : 1m/pcs, total 2 pcs with safty ring and screws.
	HS-03	A, 2pcs Pole-hang buckle with screws
	HS-04	A, 1 Connection buckle(For Two or more modules) with screws
	HS-05	A, Adjust bracked : 1、 Surfaced mounting ; 2、 wall mounted ; 3、 ground mounted ; B, Can adjusted different beam angle. Maximum 90°. C, 1 brackets with screws

BA- Lighting AS
Hovedgata 10, 4900 Tvedestrand